



CRAFTSMAN
ELEVATION



FARMHOUSE
ELEVATION



LOWER LEVEL

OPTIONAL FINISHED BASEMENT ADDS:

- A FAMILY ROOM
- 1 BEDROOM
- 1 BATH
- 984 FINISHED SQFT

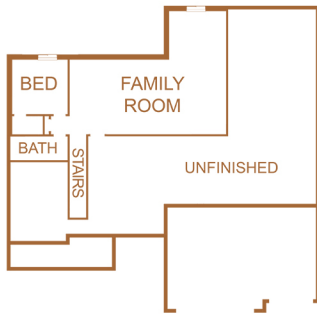

MAIN FLOOR

DUNE

DUB - SINGLE STORY

havynhomes.com



3 Beds



2 Baths



3 Garage



2,567 sqft



219.306.4500

This floor plan brochure is for illustrative purposes only. Dimensions and layouts are approximate and may vary. Some items shown are not included, but may be available as options. Please verify all details and ask a representative for more information.