



**CRAFTSMAN**  
ELEVATION



**FARMHOUSE**  
ELEVATION



## LOWER LEVEL

### OPTIONAL FINISHED BASEMENT ADDS:

- A FAMILY ROOM
- 1 BED
- 1 BATH
- 1,045 FINISHED SQFT

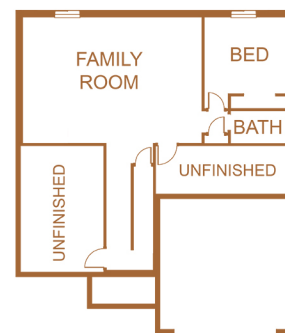

**3** Beds

**2** Baths

**2** Garage

**1,574** sqft

# CRAWFORD

CRB - SINGLE STORY



havynhomes.com



219.306.4500